

1.5mm Cable Display Systems - INSTALLATION GUIDELINES

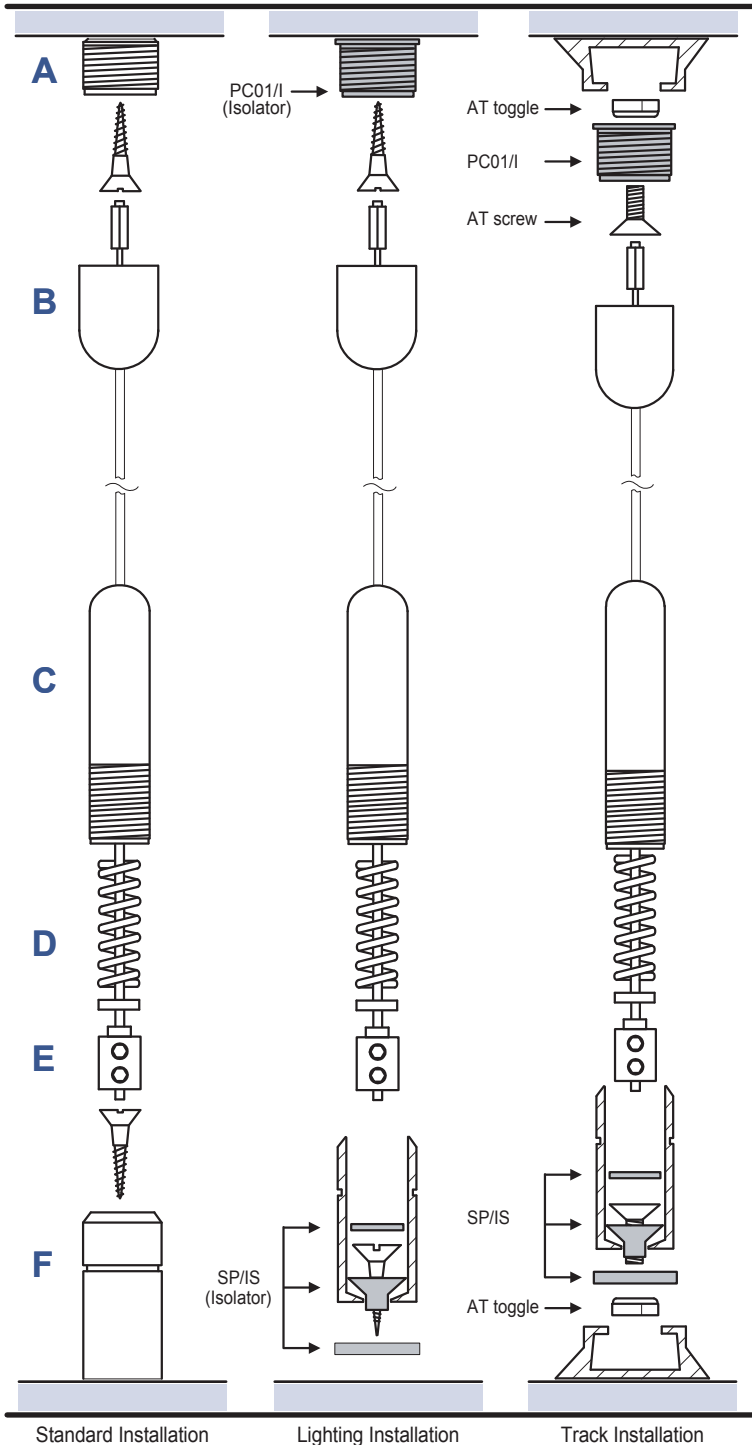
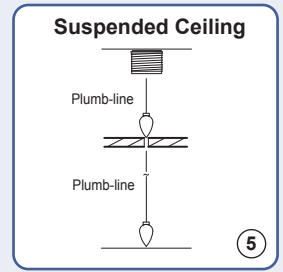
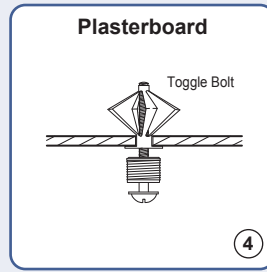
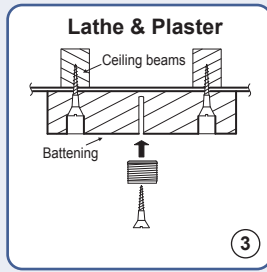
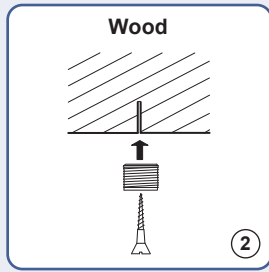
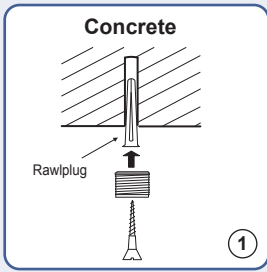

Top to Bottom (CA4) - Cable Installation

IMPORTANT: It is essential to check that the top ceiling fixings are strong enough to take the weight of the items being displayed, whilst allowing for the tension in the cables.

Isolators must be used where power is required through the cables (lighting etc) and fixings are into metal or conductive materials.

When fitting isolated cables remember to replace the top brass fitting with the plastic **PC01/I** isolator and add bottom isolator **SP/IS** to bottom fitting.

- 1) Fix fitting (A) to ceiling:
 - for wooden ceilings use a wood screw.
 - for cavity ceilings use a spring toggle bolt.
 - for solid ceilings use a rawlplug and screw.
- 2) Screw fitting (B) to fitting (A).
- 3) Using a plumb-line, plumb down from (A) and fix (F) to floor using appropriate type of fixing. For isolated cable remember to include the **SP/IS**.
- 4) Loosen the grub screws in fitting (E), using the allen key provided and slide fittings (C), (D) and (E) up the cable.
- 5) Pull down the cable and cut off in line with the decorative line around fitting (F) (see below).
- 6) Re-tighten (E) on the end of the cable.
- 7) Adjust the tension of the cable by screwing (C) into (F).

N.B. It is important to check the strength of the top fixing. No responsibility will be taken for incorrect fixing. This responsibility rests with the installer.

Cables are not supplied with fixing screws.

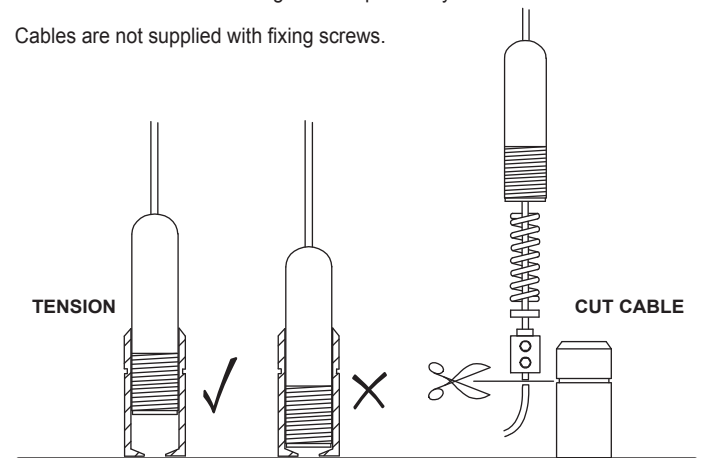

▼ Cable Display Systems - INSTALLATION GUIDELINES

CS09 Rod Support Fixing

IMPORTANT: It is essential to check that the top ceiling fixings are strong enough to take the weight of the items being displayed, whilst allowing for the tension in the cables.

- 1) Install cables as per "**Cable Fixing Instructions**" for **CA4** supplied.
- 2) Fix rod supports (**A**) onto cables. Adjust supports vertically and horizontally, preferably with a spirit level. Repeat procedure for other supports.
- 3) Un-tighten the set screws on the rod support (**B**) and slide the rod (**C**) into the open cavities at required position, and tighten back the set screws with Allen Key provided. Rod needs to be cut to size before attaching to the cable.
- 5) Attache the decorative end cap (**D**) to both ends of the rod.
- 5) Attache your acrylic accessories (**E**) to the rod.

N.B. It is important to check the strength of the ceiling fixings. No responsibility will be taken for incorrect fixing. This responsibility rests with the installer.

Cables are not supplied with fixing screws.

